

"The Residence." *Like no other*





*For people who prefer
the luxury of space.*

For some, luxury of space is a matter of choice.
They like it when it's open and spacey.
Where rooms don't resemble a compromise.

The Residence is for people like these. For a start let's just have a look at the smallest unit. At 1444.42 square feet built up area (mind you not super built up), here's an apartment that sets the tone for a grand lifestyle. There's practically everything here. You name it. It has it. Infact a little more.

Two Pools. One on the 8th Floor.

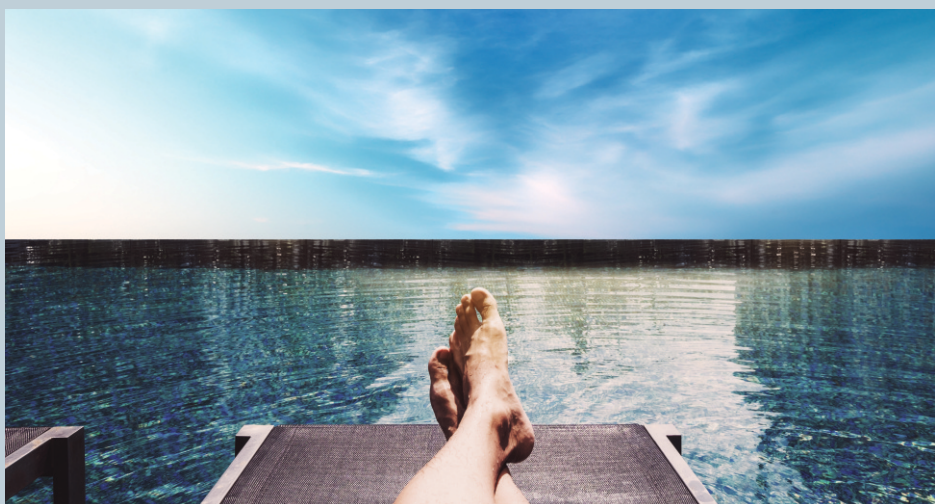

The Residence is unlike any other apartment. Not because it wanted to be "different". It was always a matter of delivering an edge. The pool on the 8th floor just making the whole experience of living a lot more special. Not that the pool on the ground floor is any less special. But an infinity pool opening up into the sky has its own high.

3 BHK premium

Built Up Area - 1444.42 sq.ft.

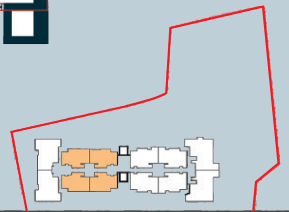
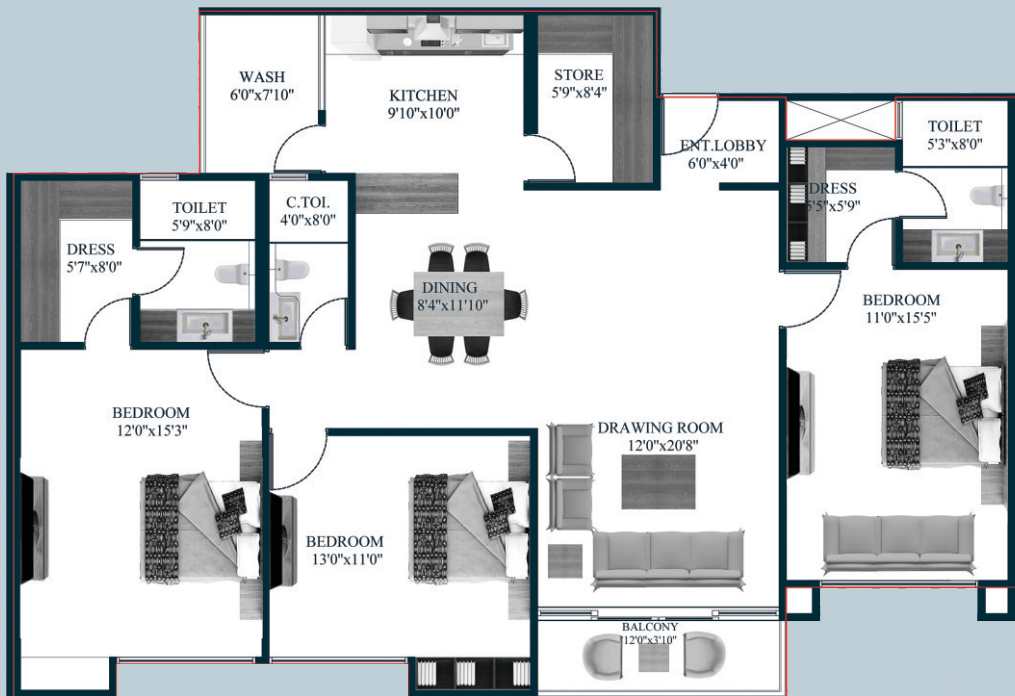

3 BHK Super premium

Built Up Area - 1636.77 sq.ft.

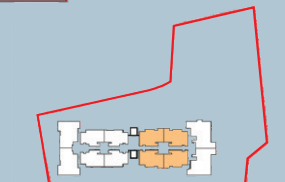
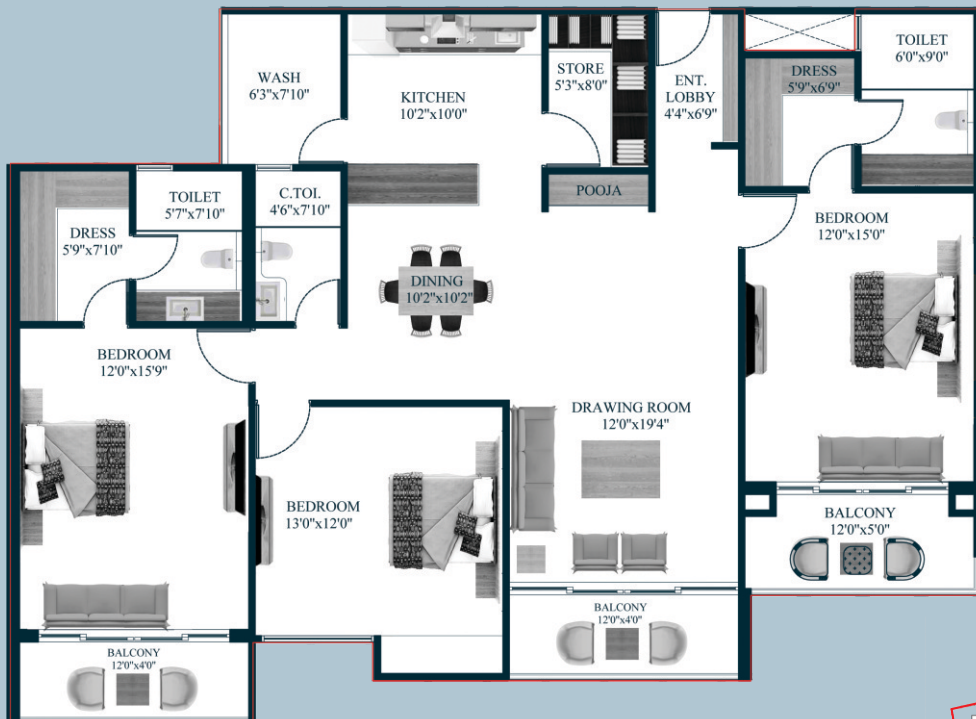

4BHK Premium

Built Up Area - 2060.44 sq.ft.

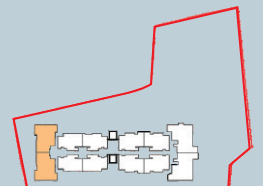
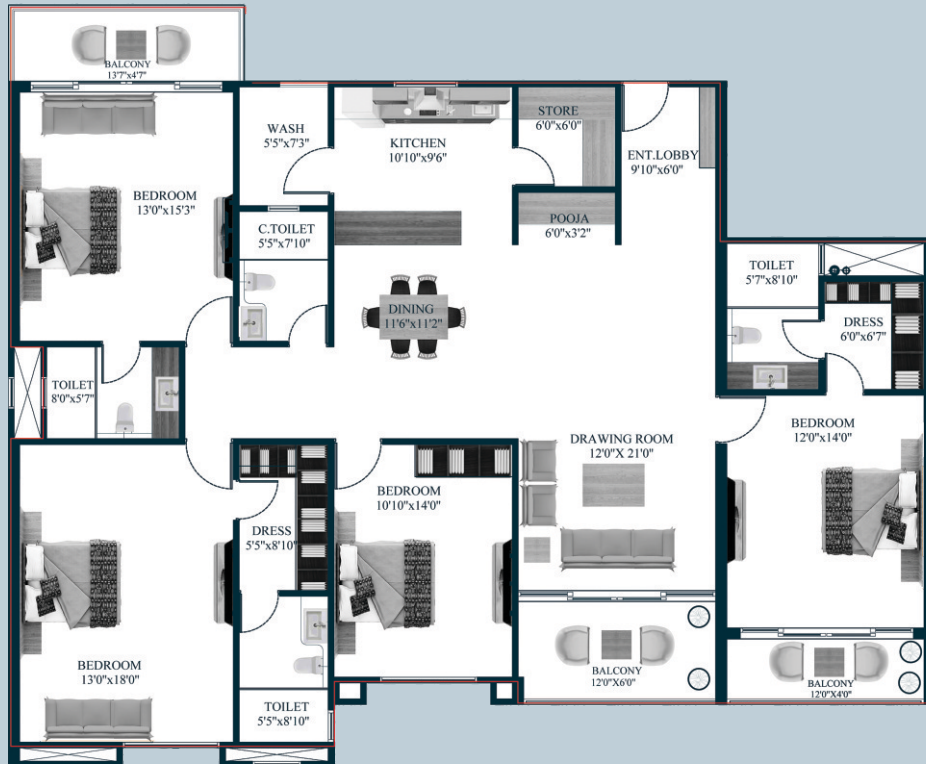

4 BHK Super Premium

Built Up Area - 2387.13 Sq.ft.

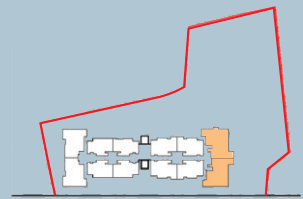



















What a Location !

They say, a house is as good as its location. So what better, than a place in close vicinity with Scheme No. 140 and Agrawal Public School. The location is spot on! considering its proximity to the lively city life. But what will impress you most, is the right kind of gentry around.







The expected and the not so expected project highlights-

-  Badminton court
-  Skating track
-  Basketball court
-  Shooting range
-  Double height lobby with AC
-  2 Swimming pools (1 Infinity pool)
-  Cricket net with bowling machine
-  Mini theater
-  Squash court
-  Gaming zone
-  Billiards table
-  Card room
-  Guest room
-  Community hall
-  Service elevator
-  Fully equipped gymnasium with sauna and steam
-  Automatic car wash
-  Bird control system and many more



Location Map



	AIRPORT	<15 K.M.		PASSPORT OFFICE	<1 K.M.
	RAILWAY STATION	<6.7 K.M.		AGARWAL SCHOOL	<1 K.M.
	HANS TRAVEL	<2.5 K.M.		AKASH HOSPITAL	<1 K.M.

THE RESIDENCE

MAZE BUILDCON PRIVATE LIMITED

Site Office: The Residence, khasra 93/1 Bicholi Mardana, Behind Vaishnav Dham Mandir,
 Near Agarwal Public School (IDA Scheme 140), Indore - 452016
 Ph: 07772045000, 07772046000 | E-mail: mazebuildcon@gmail.com

Disclaimer: Site map, sizes of the units and amenities shown in the brochure is subject to any further modification/ changes as an when required. The same shall not be construed to be a promise by the developer and shall not be made subject matter of any legal action.

T&CP and Building Permission granted.