

SOLITAIRE PARK

NAME	KHASARA NO.	AREA
NALANDA INFRASTRUCTURE PVT. LTD.	252/1/ meen-1	2.528 hect.
TARFE DIRECTORS :-	252/2/1	1.769 hect.
SHRI SANJAY AGRAWAL S/O SHRI DINANATH AGRAWAL	252/2/2/1	0.809 hect.
ADD.:- 9, PRAGATI VIHAR, BICHOLI MARDANA INDORE M.P.	252/2/2/2	1.214 hect.
total land area		6.320 hect.

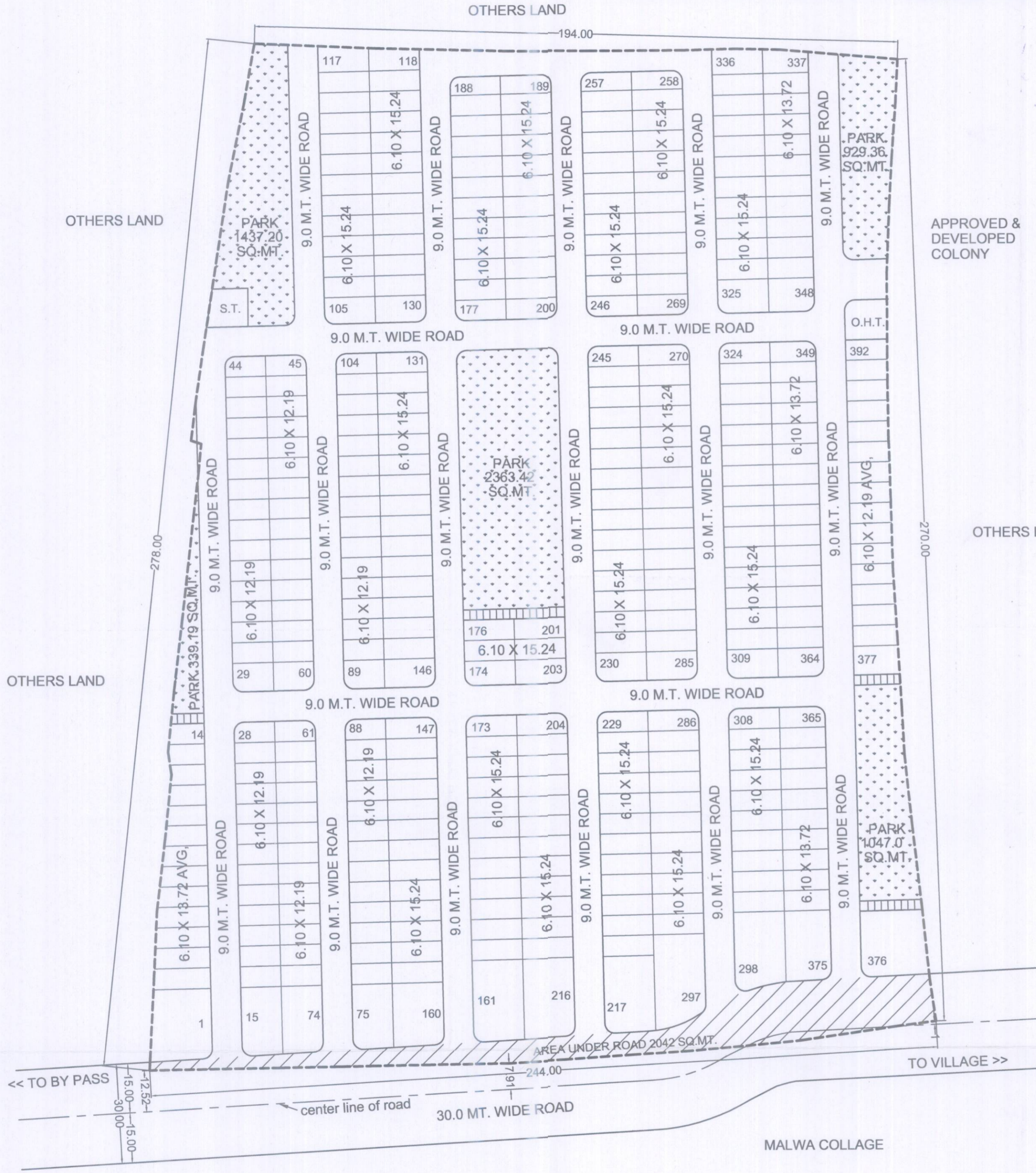
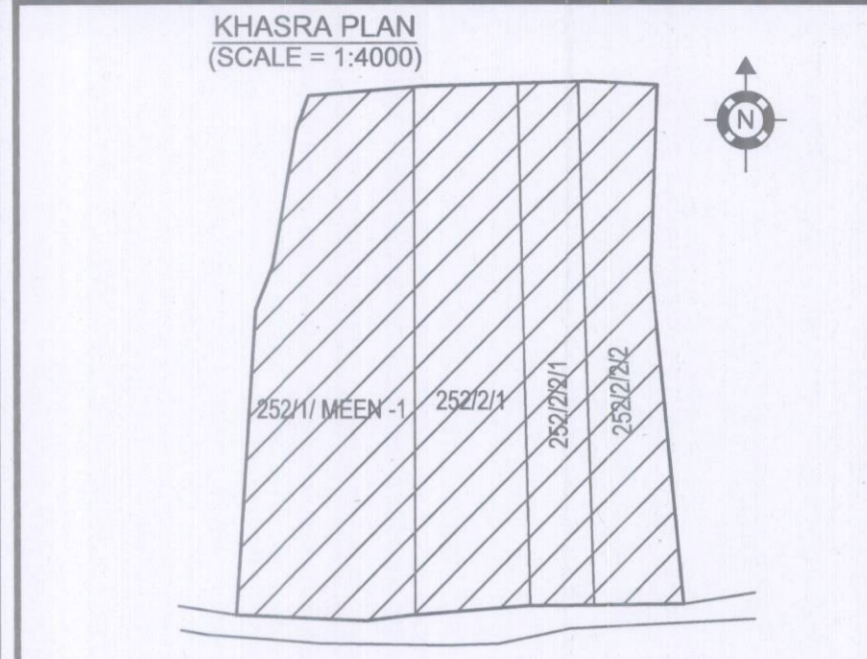
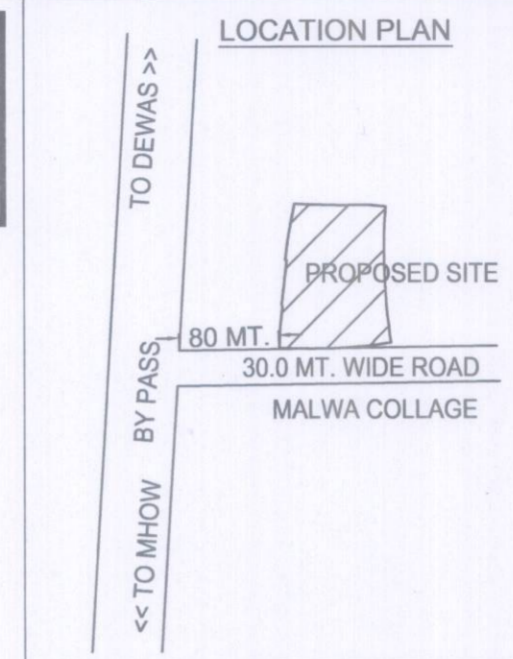

APPROVED & DEVELOPED COLONY

Valid up to 16/12/2022
APPROVED
 As Per Condition Given is
 Memo No. INDLP-6078

Singh
Joint Director
 Town & Country Planning
 Indore (M.P.)

Agarwal
Assistant Director
 Town & Country Planning
 Indore (M.P.)

Chauhan
मुक्ति लयादे
 उपयत्री

PROPOSED LAYOUT PLAN OF RESIDENTIAL COLONY BEARING KH.NO. 252/1/ MEEN -1,252/2/1,252/2/2/1,252/2/2/2, AT VILLAGE NIPANIA TEH.& DIST.INDORE
 OWNERS NAMES :-
 NALANDA INFRASTRUCTURE PVT. LTD.
 TARFE DIRECTORS :-
 SHRI SANJAY AGRAWAL S/O SHRI DINANATH AGRAWAL
 ADD.:- 9, PRAGATI VIHAR, BICHOLI MARDANA INDORE M.P.

AREA STATMENT

S.No	DESCRIPTION	AREA (SQ.M.)	PERCENTAGE
1	TOTAL LAND AREA	63200.00	
2	AREA UNDER 30.0 M. ROAD WIDENING	2042.00	
3	NET PLANNING AREA	61158.00	100%
4	PLOT AREA	37349.00	61.07%
5	PARK AREA	6115.80	10.0%
6	SERVICE AREA	611.58	1.00%
7	ROAD AREA	17081.62	27.93%

NOTE :-
 shapth patra given by client for deposit of shelter tax for informal sector

map prepared on basis of all legal & site information given by client

For Nalanda Infrastructure Pvt. Ltd.
Agarwal
Director
 OWNER'S SIGNATURE

Govind Singh Solanki
GOVIND SINGH SOLANKI
 TOWN PLANNER & CIVIL ENGRG.
 LIC. NO. 285/TNC
 SIGNATURE OF T. & C.P. LIC. NO.
 TNC.P., INDORE (2019-2020)
 CONTACT NO. 9782828282

